

The City of GARDEN GROVE

connections

Winter 2023/Spring 2024

BROOKHURST PLACE PHASE II

Located in OC Koreatown, the final phase of Garden Grove's largest residential and commercial mixed-use development is now under construction.

Brookhurst Place Phase II will offer up to 462 apartment homes, 58 condominiums, up to 200,000 square-feet of commercial and retail space, and 100-key hotel, urban trail, and a public park.

ggcity.org/brookhurst-place



BROOKHURST
PLACE

Find out how Garden Grove is focusing on unique and innovative projects and services.

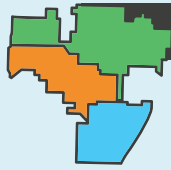

CENTRAL CITIES NAVIGATION CENTER

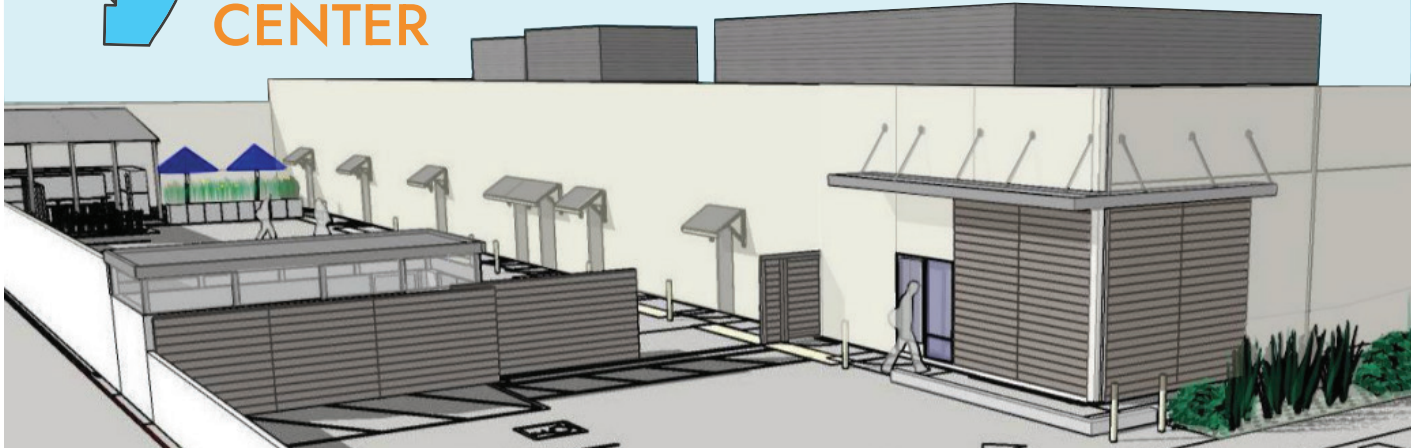

The City's first navigation center is currently under construction—one of the City's many collaborative efforts to create a solution to homelessness.

The Central Cities Navigation Center will be a referral-based, transitional facility that will offer emergency housing and wrap-around services to individuals experiencing homelessness from Garden Grove, Fountain Valley, and Westminster.

ggcity.org/navigation-center



Home2 Suites by Hilton, the City's first new hotel development located south of the Grove District Anaheim Resort, is now open for visitors to enjoy Southern California's popular attractions.

ggcity.org/home2-suites-hilton

GARDEN BROOK SENIOR VILLAGE

Garden Brook Senior Village, the 8-story adaptive reuse project in OC Koreatown with commercial space and senior-living units, is now complete and in full capacity.

Partnering with the neighboring Boys and Girls Club of Garden Grove, seniors can enjoy programs that foster mutually-benefitting youth and senior interactions.

ggcity.org/econdev/current-projects



GG Ready is a new online software system that streamlines the building permit process. Business owners and residents can now apply for permits, check the status of a project, or schedule an inspection online. ggcity.org/development-access

MOBILE APP

As part of the City's commitment to better connect residents and business owners to City services, news, and more, the City has launched a new version of its mobile app, now available for download on iOS and Android devices.

ggcity.org/mobile-app

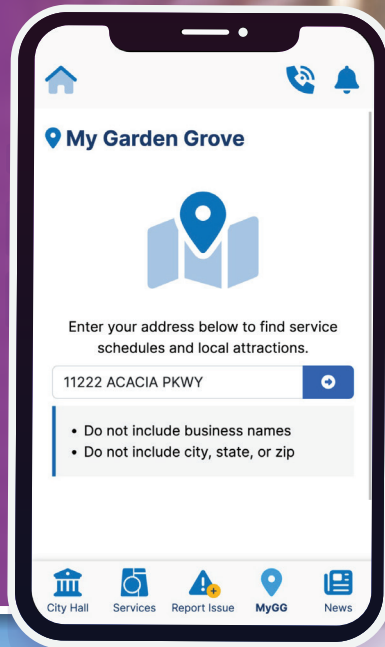

PUBLIC WORKS NEW EQUIPMENT

The Public Works Department recently obtained new operating equipment to perform a wide range of construction, maintenance, and repairs to Garden Grove streets.

Two asphalt pavers will address and rehabilitate the city's deteriorating alleyways in a timely manner that is safe and cost saving.

The skid steer with a sweeper attachment, an asphalt grinder, a concrete breaker, and a regular bucket will help perform yearly slurry projects.

GGADU

Accessory Dwelling Units (ADUs) are independent living units attached or detached to a single-family home. ADUs are innovative, affordable, and an effective option for adding much-needed housing in Garden Grove.

The City developed an ADU program to help residents, developers, contractors, and architects easily build ADUs in compliance with the City's ordinance.

ggcity.org/adu



11222 Acacia Pkwy, Garden Grove 92840
(714) 741-5000 · ggcity.org

